

# BagMixer® 400

400 mL lab blenders



# Why choose **BagMixer®** 400!

## Best-seller

- Sold in more than 90 countries
- 35 years experience

## High-quality

- Optimal analysis with the sterile **BagFilter®** and **BagPage®**
- In compliance with ISO 7218 standard
- Made in France by **interscience**

## Brushless motor

- No wearing parts
- - 50% power consumption
- Extra silent

## Safety

- The handle closes the blender and starts the blending
- **Q-Tight®**: no leaks from the top of the bag
- Security drip tray

## PATENTED

## Click & Clean® removable paddles

- Remove the paddles and easily clean the blending chamber

## PATENTED

## Adjustable blending power

- Up to 28 kg of pressure: the hardest samples don't resist!  
e.g.: nuts, pills, seeds, dog biscuits etc.



## Easy cleaning

- All stainless steel
- Door opens at 270°
- Removable **Click & Clean®** paddles

## Guarantee

- Shock absorbers and window door **life-time** guarantee
- 3 year warranty (after registration)

## Optimal extraction

- From as little as 30 seconds
- Easy control with the digital screen (speed, time, power)

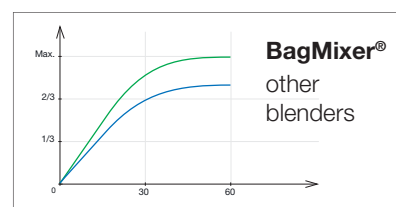

More than 15 000 **BagMixer®** in use every day!

Made in France by **interscience**,  
the only manufacturer of blenders and sterile bags for microbiological analysis

Some features are limited to specific models.  
For complete technical info, please check online:  
[www.interscience.com](http://www.interscience.com)



# BagMixer® 400 models:

The **BagMixer®** lab blender guarantees optimal extraction by the action of its two paddles. Adapted to any sample (food, agricultural, chemical, medical, environmental) to be analyzed between 50 mL and 400 mL, it guarantees homogenization in 30 to 60 seconds.



**BagMixer® 400 P**  
➤ The essential

Ref. 021 230

**BagMixer® 400 W**  
➤ Window door

Ref. 022 230

**BagMixer® 400 CC**  
➤ Click & Clean®

Ref. 024 230

**BagMixer® 400 S**  
➤ Silent blending

Ref. 025 000

**BagMixer® 400 SW**  
➤ Window door  
& LiquidSensor

Ref. 025 100

Also available: packs including bags and accessories; 100 mL and 3500 mL lab blenders. For more info, please contact us.  
For more info on **BagMixer® S & SW** models, please refer to **BagMixer® S & SW** brochure.

## BagMixer® packs:

### Starter Pack



- 1 **BagMixer®**
- **Sterile bags:** 500 BagFilter®  
+ 500 BagLight®
- **Accessories:** 50 BagClip®  
+ 1 BagOpen® + 1 BagRack®

### Classic Pack



- 1 **BagMixer®**
- **Sterile bags:** 500 BagFilter®  
+ 500 BagLight® + 500 BagPage®
- **Accessories:** 50 BagClip®  
+ 1 BagOpen® + 1 BagRack®  
+ 1 PetriPile® + 1 BagPipet®  
+ 1 000 BagTips® Regular  
+ 6 Clinet® 101

### Premium Pack



- 1 **BagMixer®** & 1 **DiluFlow®**
- **Sterile bags:** 1 000 BagFilter®  
+ 2 000 BagLight® + 1 000 BagPage®
- **Accessories:** 50 BagClip®  
+ 1 BagOpen® + 2 BagRack®  
+ 2 PetriPile® + 1 BagPipet®  
+ 1 000 BagTips® Regular  
+ 6 Clinet® 101

## BagSystem® complete range for sample preparation before analysis

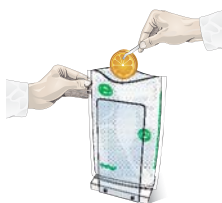

**BagFilter®**  
Collect

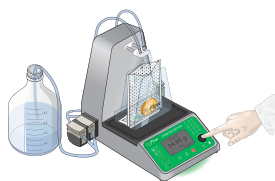

**DiluFlow®**  
Dilute







**BagMixer®**  
Blend



**BagTools®**  
Pipet

# Technical specifications

		BagMixer® 400 P	BagMixer® 400 W	BagMixer® 400 CC
	Reference	021 230	022 230	024 230
Key features	Removable and autoclavable paddles, <b>Click &amp; Clean®</b> system	-	-	✓
	Blending power indicator	-	-	✓
	Adjustable blending power (up to 28 kg of pressure)	-	-	✓
	Digital screen	-	-	✓
	Leak free <b>Q-tight®</b> system	-	-	✓
	Side-by-side paddle stop	-	-	✓
	Silent brushless motor	-	-	✓
	Window door	-	✓	✓
	Security drip tray	in option	✓	✓
	270° opening door	✓	✓	✓
	All stainless steel	✓	✓	✓
	Compact and ergonomic	✓	✓	✓
Technical specifications	Door weight	1050 g	950 g	
	Blending time	30, 60, 90, 120, 150, 180, 210 sec., ∞		from 1 sec. to 59 min, ∞
	Blending speed	fixed speed: 8 strokes/sec.		variable speed: 4, 6, 8, 10 strokes/sec.
	Dimensions (w x d x h)	27 x 38.5 x 28 cm		27 x 41.5 x 26.5 cm
	Weight	16.6 kg		16 kg
	Power	110-127/220-240 V~ 50-60Hz		100-240 V~ 50-60Hz
	Capacity	50-400 mL		
Warranties	Made in France	✓	✓	✓
	Life-time warranty	Unbreakable shock absorbers and window door		
	3 year warranty (after registration)	✓	✓	✓
Manufactured in compliance with				  

## Discover our complete range for microbiology



**BagFilter®**  
Sterile bags



**DiluFlow®**  
Gravimetric dilutors



**FlexiPump®**  
Peristaltic pumps



**easySpiral Dilute®**  
Automatic diluter and platers



**Scan®**  
Automatic colony counters  
& inhibition zone readers

Proudly Distributed by:

**Cell  
Biosciences**

Ph: 03 9416 7177  
Fax: 03 8678 3956  
email: [info@cellbiosciences.com.au](mailto:info@cellbiosciences.com.au)  
Web: [www.cellbiosciences.com.au](http://www.cellbiosciences.com.au)

### interscience

30, chemin du Bois des Arpents - 78860 St Nom - FRANCE  
T: +33 (0)1 34 62 62 61 - F: +33 (0)1 34 62 43 03 - Email: [info@interscience.com](mailto:info@interscience.com)

### interscience

USA & CANADA

32 Cummings Park - Woburn, MA 01801 - USA  
T: +1 781 937 0007 - F: +1 781 937 0017 - Email: [sales.usa@interscience.com](mailto:sales.usa@interscience.com)

### interscience

CHINA

上海市徐汇区吴兴路277号锦都大厦588室 - 200030  
电话: +86 (0)21-64739390 - +86 189 3097 0733 - 邮址: [sales.china@interscience.com](mailto:sales.china@interscience.com)

### interscience

SOUTH-EAST ASIA

541 Orchard road - 09-01 Liat Towers - SINGAPORE 238881  
T: +65 6933 1389 - +65 8549 1217 - Email: [sales.asia@interscience.com](mailto:sales.asia@interscience.com)

[www.interscience.com](http://www.interscience.com)



# DiluFlow<sup>®</sup>

Gravimetric dilutors for solid samples



The best solution for your dilutions!

**Cell**  
BioSciences

interscience



## Our quality for your lab

- Full range of products for microbiological analyses
- Leadership for innovative products
- Worldwide distribution network
- Designed and Made in France





# BagSystem®

## for the best sample preparation

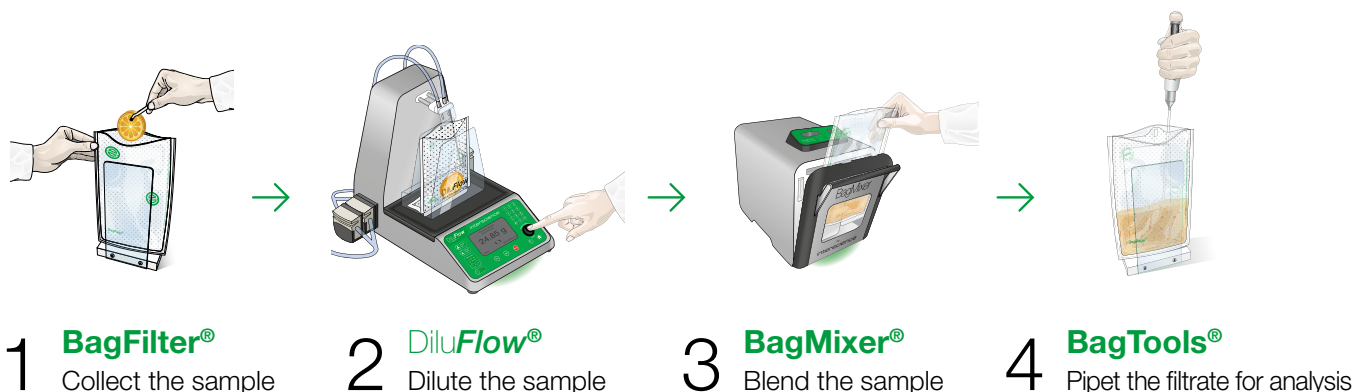

## Why use a gravimetric dilutor?

DiluFlow® gravimetric dilutors enable the automatic dilution of the sample with perfect reliability. See the following advantages:

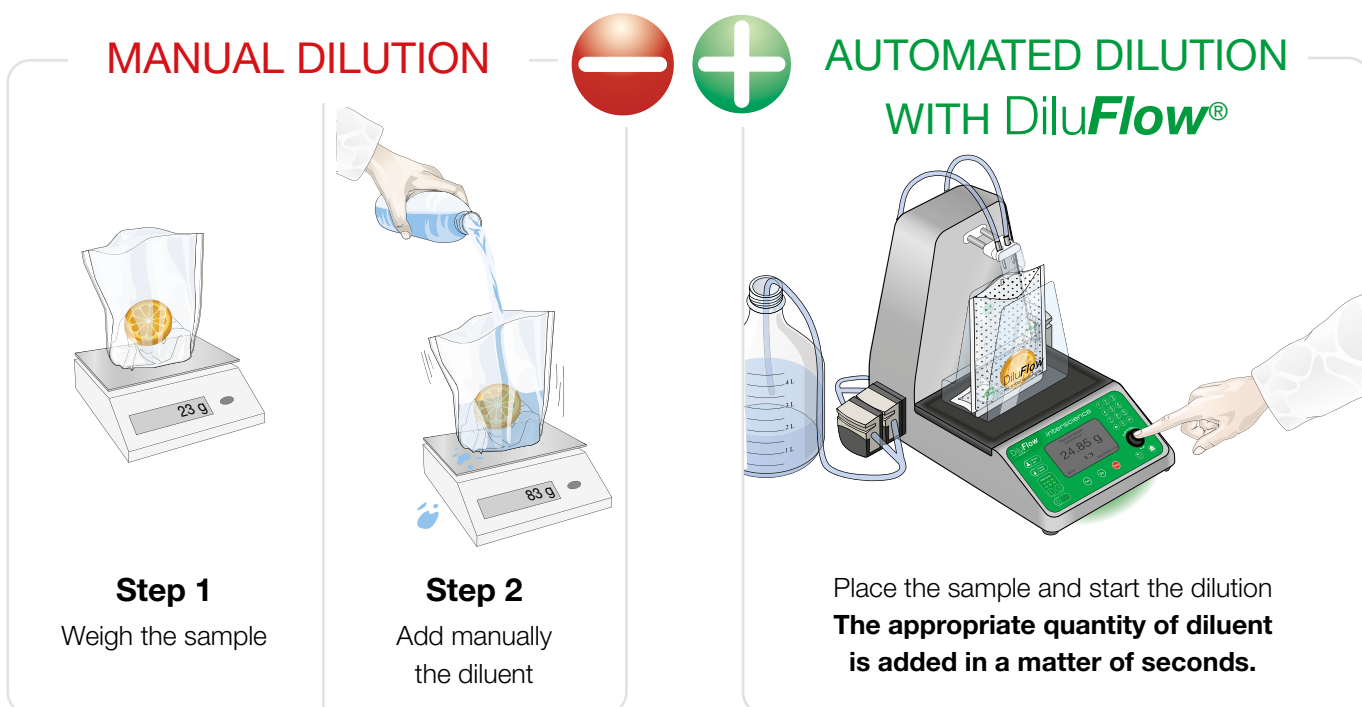

**Time-consuming** ■

**Inaccurate:** ■  
Direct impact on final result

**Not reproducible** ■

**Not secure:** ■  
The bag is not maintained

**Not automatically traceable** ■

■ **Quick:** 8 seconds\* for 225 mL

■ **Accurate:** < 1 % of sample weighing  
As little as < 1 % of dispensing  
(in standard or accurate mode)

■ **Reproducible**

■ **Secured:** The bag is maintained  
with BagOpen® bag opener

■ **Traceable:** with LIMS, printer or Excel™

\* Dilution time for a 25 g sample diluted at 1/10 on a DiluFlow® Elite with booster kit in fast mode

# Easy-to-use efficient & connected

## 3 models for optimal dilutions



DiluFlow®



DiluFlow® Pro



DiluFlow® Elite

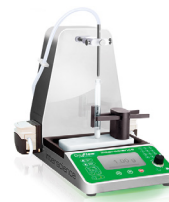

DiluFlow® Elite 1 kg

Ultra low profile	✓	✓	✓	✓
DripTray	✓	✓	✓	✓
Robotic arm	-	✓	✓	✓
Jumbo kit option	-	✓	✓ <sup>(8)</sup>	-
Programmable	-	-	✓	✓
Full traceability	-	-	✓	✓
Up to 6 pumps	-	-	✓	✓
Multi-Dispensing	-	-	✓	✓

### Superior quality

Watson Marlow™ pumps



### Traceability

Printer, USB stick<sup>(1)</sup>, Excel™, Open Office™, CSV, LIMS<sup>(1)</sup>



### Up to 6 diluents

With 4 extra connectable pumps<sup>(1)</sup>

IN COMPLIANCE WITH



### 304 L stainless steel casing

For easy cleaning and long-lasting

## Robotic arm<sup>(2)</sup>

Easy sample dropping  
Avoids contamination  
Saves time

Demo video  
Scan me !



## GeckoGrip

No more adhesive gums!  
Ultra adhesive, hygienic and long lasting  
**PATENTED**

## Ultra low profile

Perfect for a laminar flow  
Ergonomic: no more  
musculoskeletal disorders

## Kit booster

2 times faster

Only 30 cm!

## Removable DripTray

Easy to keep your DiluFlow® clean  
**PATENTED**

## High accuracy weighing scale

Weighing accuracy up to 99 %





# Unique features

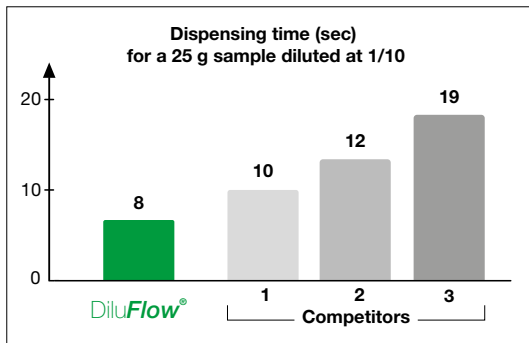

## World's fastest dilutor:

With a booster kit, the Dilu**Flow**® are the fastest dilutors on the market. Only 8 s<sup>(3)</sup> to dispense 225 mL!

## Robotic arm<sup>(2)</sup> & nozzle protection plate

The robotic arm enables you to drop the sample safely and easily without contamination risks. Tested more than 1.3 million times, its reliability is guaranteed.

The protective plate protects the nozzle from any contact with the sample.

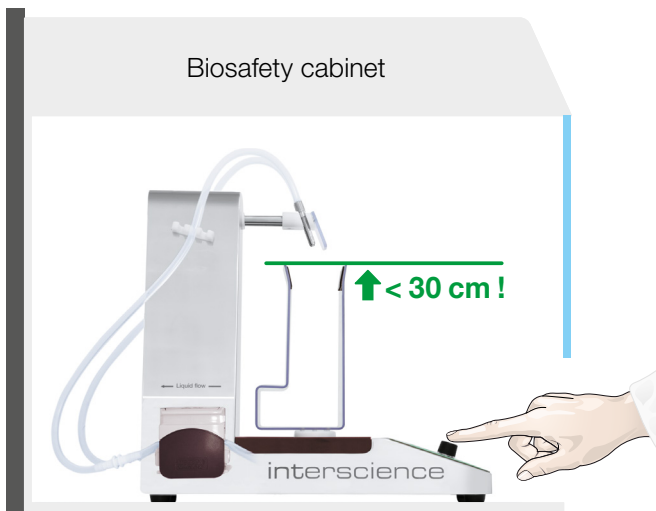
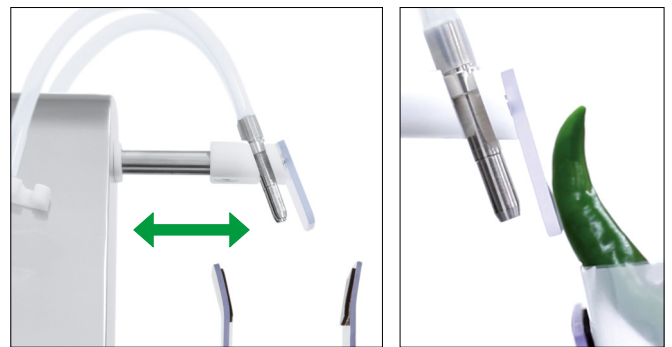

## Ultra low profile

The Dilu**Flow**® have the lowest bag opening on the market, less than 30 cm!

This allows a better comfort and ergonomics, especially when you use the DiluFlow in a biosafety cabinet.

## GeckoGrip gripping system

Inspired by a gecko's paw, this new GeckoGrip material will hold the bag without pressing hard. GeckoGrip sticking properties apply in dry and wet surfaces.

GeckoGrip long lasting material can be washed with soap and alcohol.

**PATENTED**





## LightCode

An intuitive indicator of the status of the DiluFlow®. The degree of accuracy of the finished dilution is displayed: green > 98 %, orange > 95 % or red < 95 %. It will also turn blue if the scale is not stable, thus telling you to wait for stabilization.



**Green:**  
Accuracy > 98 %



**Orange:**  
Accuracy > 95 %



**Red:**  
Accuracy < 95 %



**Blue:**  
Scale stabilizing

## DripTray

In case culture media is spilt on the unit, the new patented DripTray can be removed to be rinsed, avoiding a tedious cleaning of the unit.

**PATENTED**



## Multi-Dispensing<sup>(1)</sup>

This unique patented mode allows you to serially dispense in small containers such as 9 mL tubes, without having to weigh each tube, by doing just one calibration on the scale.

**PATENTED**

## Magnetic BagOpen®

The 2 points magnetic attachment of the **BagOpen®** guarantee a stable platform for better measuring accuracy, and provide a natural protection of the weight sensor when removing the bag.

**PATENTED SHAPE**

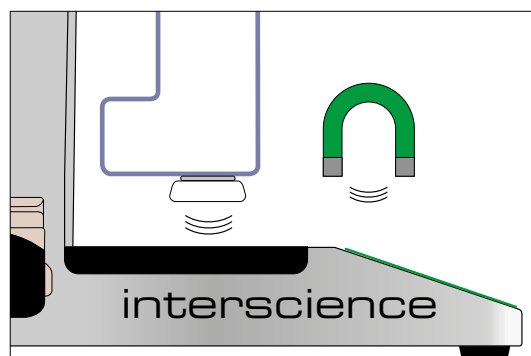

(1) Only on DiluFlow® Elite (2) Only on DiluFlow® Pro and DiluFlow® Elite (3) Dilution time for a 25 g sample diluted at 1/10 on a DiluFlow® Elite with booster kit

# Multiple ways to use a DiluFlow®

## ☞ The lab operators like the low profile of the DiluFlow® platform ☞

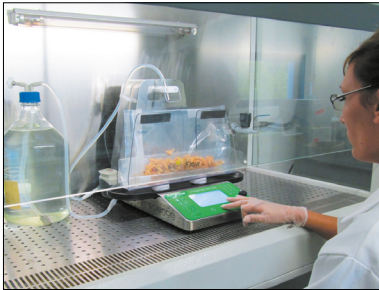

New standards make it necessary to work under a laminar flow for the dilution work, and this can create operational problems.

Our lab operators like the ultra-low profile of the DiluFlow® platform because they do not need to bend themselves anymore to insert the sample in the bag.

My DiluFlow® can handle up to 5 000 g load if you add the Jumbo kit option, to dilute in large bags. It is useful because you do not need to buy an extra machine for large samples.

■ Brigitte, lab technician

## ☞ The DiluFlow® Elite, in the 1 kg version, has an accuracy of 0.01 g ☞



In the cosmetics industry, the raw materials cost a fortune, sometimes more than 10 000 euros per kilo ! That is why we only work with small amounts, usually 1 g.

The DiluFlow® Elite, in 1 kg version, has an accuracy of 0.01 g, which enables us to get  $\pm 2\%$  weighing accuracy. Moreover we use the tongs platform option which are efficient pliers to hold our tubes, to directly place the tube under the liquid flow every time.

■ Dylan, lab manager

## ☞ Accurate, user-friendly and reliable... ☞



We analyze between 10 and 20 samples per day in our lab.

We looked at all dilutors on the market and most of them looked far too complex to use or too sophisticated.

We are now using a DiluFlow® which matches our requirements completely. The keyboard is really easy-to-use; only 2 keys to press for a dilution.

■ Alain, microbiological coordinator



## ☞ 3-in-1 equipment ☞

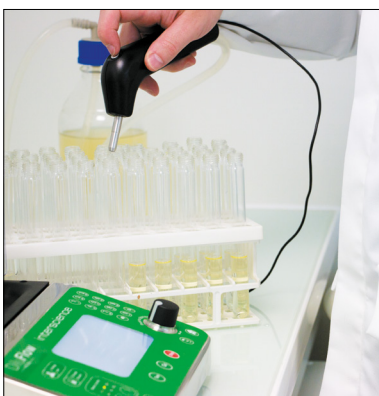

What I really like about my DiluFlow® Elite is the Multi-Dispensing function. I use it to fill 9 mL dilution tubes. Before that, I was using a peristaltic pump, but each time, I had to calibrate the pump with a weighing platform to get  $\pm 2\%$  accuracy.

With the DiluFlow® Elite, you just put the first tube on the platform and the calibration is automatic. You can then directly distribute the doses in the tubes with the HandyGun, without having to weigh each tube. It is as if I had 3-in-1 equipment: a peristaltic pump, a scale and a dilutor!



■ Dominique, quality control engineer

# Traceability

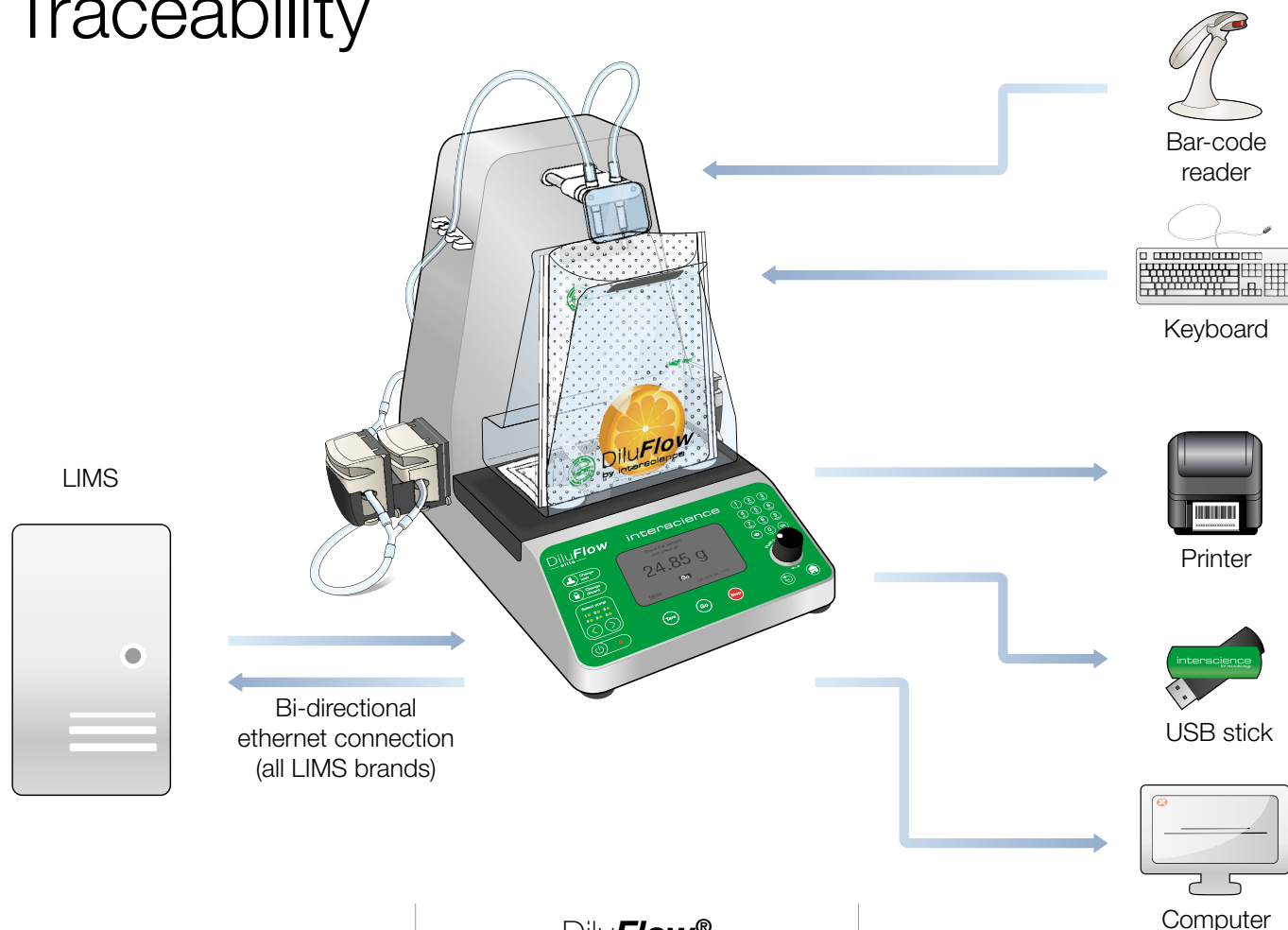

DiluFlow®  
DiluFlow® Pro

DiluFlow® Elite

## Available ports

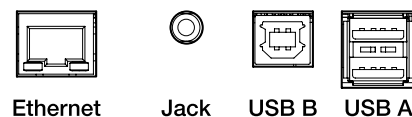
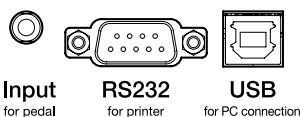

## Data export to a printer

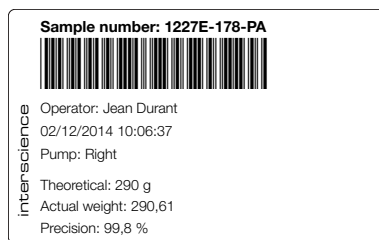

\* Printed via the supervision software

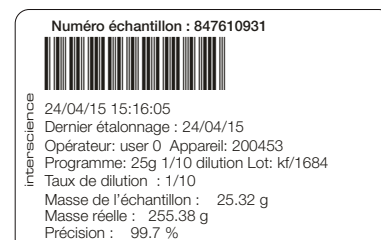

\* Printed directly from the DiluFlow® Elite

## Import and export of computer & network data

### Traceability :

- USB connection to computer and data export via the DiluFlow® supervision software
- Excel™ file export from the supervision software

### Full traceability :

- Data export to Excel™
- Data export to USB key (CSV)
- Bi-directional connectivity to the LIMS by Ethernet



# How to order



## DiluFlow®

Single pump (3 kg)  
Double pump (3 kg)

**Ref 501 103**  
**Ref 501 203**



## DiluFlow® Pro

Single pump (5 kg)  
Double pump (5 kg)

**Ref 502 105**  
**Ref 502 205**



## DiluFlow® Elite

Single pump (1 kg)  
Double pump (1 kg)  
Single pump (5 kg)  
Double pump (5 kg)

**Ref 503 101**  
**Ref 503 201**  
**Ref 503 105**  
**Ref 503 205**

DiluFlow® is delivered with 1 distribution arm, 1 drip tray 400, 1 or 2 pumps, 1 distribution assembly (GL45 - Ø 6.4 mm) per pump, 1 USB cable, 1 supervision software, 1 power cord, 1 BagOpen® 400 for dilutor, 1 user's manual, 1 conformity certificate / warranty card, 10 GeckoGrip, 1 pack of adhesive putty, blender bags samples.  
DiluFlow® Pro is delivered with 1 drip tray 400, 1 or 2 pumps, 1 protection for distribution nozzle, 1 distribution assembly (GL45 - Ø 6.4 mm) per pump, 1 USB cable, 1 supervision software, 1 power cord, 1 BagOpen® 400 for dilutors, 1 user's manual, 1 conformity certificate / warranty card, 10 GeckoGrip, 1 pack of adhesive putty, 1 Allen wrench, blender bags samples.  
DiluFlow® Elite is delivered with 1 drip tray 400, 1 or 2 pumps, 1 protection for distribution nozzle, 1 distribution assembly (GL45 - Ø 6.4 mm) per pump, 1 USB key, 1 USB cable, 1 power cord, 1 BagOpen® 400 for dilutors, User's Manual, 1 conformity certificate / warranty card, 10 GeckoGrip, 1 pack of adhesive putty, 1 Allen wrench, blender bags samples.

## Accessories



### Printer

Thermal printer (RS 232 and USB output).

**Ref 410 150**



### Foot pedal

For hands-free dispensing. Connection with a 3.5 mm Jack

**Ref 507 008**



### Bar-code reader (1)

Bar-code reader

**Ref 522 000**



### Handy Gun (1)

Dispensing control with handy gun including electronic start button

**Ref 561 001**



### Booster kit

Booster pump + 2 silicone tubings for pump part (20 cm each), inner Ø 6.4 mm + 2 "Y"

**Ref 511 000**



### Pump module (1)

External module with single pump + 513 043: Dispensing assembly (GL45 - Ø 6.4 mm)

**Ref 505 007**



### Jumbo kit (2)

BagOpen® 3500 + bac de récupération 3500 + extension anti-éclaboussure pour embout de distribution + GeckoGrip

**Ref 505 006**



### 5L bottle (GL45)

GL45 glass bottle (5L), autoclavable

**Ref 513 001**



### 2L bottle (GL45)

Set of 3 GL45 glass bottle (2L), autoclavable

**Ref 413 002**



### Independent stand for broth bags

Independent stand for broth bags

**Ref 513 015**

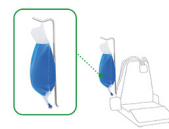

### Integrable stand for broth bags

Integrated to the unit, to hold one broth bag. Delivered with 4 screws + Torx screwdriver

**Ref 505 010**

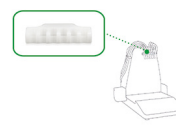

### 6 nozzles holder (1)

Can hold up to 6 nozzles

**Ref 505 008**

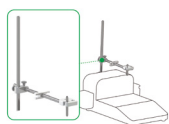

### Adjustable distribution system (3)

Ideal to fill various containers

**Ref 505 004**

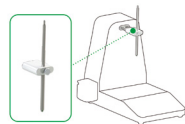

### Adjustable distribution system (4)

Ideal to fill various containers.

**Ref 505 005**

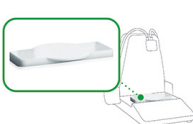

### Weighing platform

To hold a tube (Ø 10 to 60 mm). No delivered with tube.

**Ref 505 002**



### Tongs platform

To hold a tube (Ø 10 to 60 mm). No delivered with tube.

**Ref 505 003**



### BagOpen® 80/100 mL for dilutors

Bag holder for 80/100 mL bags for DiluFlow®

**Ref 505 014**



### BagOpen® 400 for dilutors (stainless steel)

Stainless steel stand for 400 mL bags

**Ref 505 016**



### Film for printer

Thermal transfer film

**Ref 410 130**



### Paper for printer

Set of 2 thermal paper rolls for printer

**Ref 521 110**



### Sticker for printer

Set of 2 rolls of 1000 stickers for thermal printer - Label size: 70 x 45 mm

**Ref 521 012**



### Certified standard weight (500 g)

500 g COFRAC calibrated weight, type F1

**Ref 513 005**



### GeckoGrip

Set of 10 adhesives for DiluFlow® BagOpen® 400 and 3500

**Ref 505 009**



### GeckoGrip

Set of 10 adhesives for DiluFlow® BagOpen® 80/100

**Ref 505 015**

(1) Only on DiluFlow® Elite (2) Only on DiluFlow® Pro and DiluFlow® Elite 5 kg (3) Only on DiluFlow® (4) Only on DiluFlow® Pro and DiluFlow® Elite



## Tubings

## Complementary products

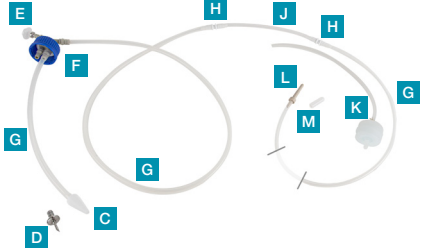
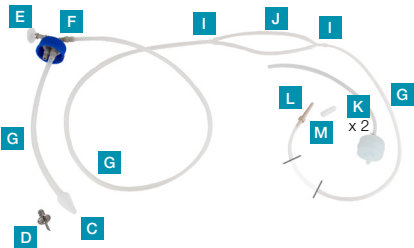
A Dispensing assembly		B Dispensing assembly for Booster Kit / FlexiPump® Pro	
			
<b>C</b> Tube weight	<b>H</b> Straight connectors	<b>L</b> Nozzles	
<b>D</b> Trocar	<b>I</b> Y connectors	<b>M</b> Protection cap	
<b>E</b> PTFE filter	<b>J</b> Tygon™ tubings for pump		
<b>F</b> Autoclavable GL45 stopper	<b>K</b> Tubings Tygon™ for pump with 0,2 µm filter		
<b>G</b> Silicone tubings			

Ref	Code	Designation	Quantity	DiluFlow®	DiluFlow® Pro	DiluFlow® Elite 5kg	DiluFlow® Elite 1kg
505 012	L	Adjustable nozzles (L 23.5 cm - tubings Ø 3.2 mm)	5	•	•		•
505 013	L	Adjustable nozzles (L 12 cm - tubings Ø 6.4 mm)	5	•	•	•	
505 017	M	Nozzle cap for trocar	10	•	•	•	•
505 018	M	Nozzle cap (Ø 1.6 - 3.2 mm)	10	•	•	•	•
513 008	B	Booster kit dispensing assembly (GL45 - Ø 3.2 mm)	1	•	•	•	•
513 009	G J I	Tubings + Y (Ø 3.2 mm)	5	•	•	•	•
513 011	J	Tubings for pump (Ø 4.8 mm)	6	•	•	•	
513 016	D G H J L M	Dispensing assembly for broth bags (Ø 4.8 mm)	1	•	•	•	
513 020	D	Trocar	1	•	•	•	•
513 023	E	PTFE filters 0.2 µm (Ø 25 mm)	5	•	•	•	•
513 024	L M	Nozzles (tubings Ø 4.8 - 8 mm)	5	•	•	•	•
513 039	C	Tube weights (Ø 6 mm)	5	•	•	•	•
513 040	L M	Nozzles (tubings Ø 1.6 - 3.2 mm)	5	•	•	•	•
513 041	B	Booster kit dispensing assembly (GL45 - Ø 6.4 mm)	1	•	•	•	•
513 042	G J I	Tubings + Y (Ø 6.4 mm)	5	•	•	•	•
513 043	A	Dispensing assembly (GL45 - Ø 6.4 mm)	1	•	•	•	•
513 044	G H J	Tubings (Ø 6.4 mm)	5	•	•	•	•
513 045	A	Dispensing assembly (GL45 - Ø 3.2 mm)	1	•	•	•	•
513 047	G H J	Tubings (Ø 3.2 mm)	5	•	•	•	•
513 048	M	Nozzle cap (Ø 1.6 - 3.2 mm)	10	•	•	•	•
513 050	A	Dispensing assembly with 0.2 µm filter (GL45 - Ø 6.4 mm)	1	•	•	•	•
513051	B	Dispensing assembly + Y with 0.2 µm filter (GL45 - Ø 6.4 mm)	1	•	•	•	•
513 052	K	Tubings for pump with filter 0.2 µm (Ø 6.4 mm)	2	•	•	•	•
561 302	J	Tubings for pump (Ø 3.2 mm)	6	•	•	•	•
561 304	J	Tubings for pump (Ø 6.4 mm)	6	•	•	•	•
561 401	E F	Autoclavable GL45 stopper + 0.2 µm filter	1	•	•	•	•
561 403	H	Straight connectors (tubings Ø 6.4 - 8 mm)	6	•	•	•	•
561 404	H	Straight connectors (tubings Ø 3.2 - 4.8 mm)	6	•	•	•	•
562 401	I	Y connectors (tubings Ø 6.4 - 8 mm)	6	•	•	•	•
562 402	I	Y connectors (tubings Ø 3.2 mm)	6	•	•	•	•



**BagMixer®**  
Lab blenders

Models (mL) :  
100/400/3500



**BagFilter®**  
Lateral filter bag

Models (mL) :  
400/3500



**BagPage®**  
Full-page filter bag

Models (mL) :  
100/400/3500



**BagLight®**  
Non-filter bag

Models (mL) :  
100/400/3500



**BagOpen®**  
Bag opener/holder

Models (mL) :  
80/100 - 400 - 3500



**BagRack®**  
Storage rack for bags

Models (mL) :  
80/100 - 400  
3500 (2/4 compartments)



**BagClip®**  
Closing clip

Models (mL) :  
80/100 - 400 - 3500



**BagPipet® & BagTips®**  
Fixed volume pipet  
& sterile tips

**BagTips® Models:**  
Regular (19 cm)  
Jumbo (24 cm)



**BagSeal®**  
Thermal sealing unit

For bags  
up to 2000 mL



**PetriPile®**  
Petri dish storage stack

Models (ø) :  
55 - 65 - 90 - 150 mm

# Technical specifications

	DiluFlow® 3 kg		DiluFlow® Pro 5 kg		DiluFlow® Elite 5 kg		DiluFlow® Elite 1 kg	
	Single pump	Double pump	Single pump	Double pump	Single pump	Double pump	Single pump	Double pump
Reference	501 103	501 203	502 105	502 205	503 105	503 205	503 101	503 201
BagOpen height < 30 cm		✓		✓		✓		✓
Removable drip tray (Patented)		✓		✓		✓		✓
BagOpen with GeckoGrip system (Patented)		✓		✓		✓		✓
Magnetic stand for BagOpen (Patented shape)		✓		✓		✓		✓
LightCode: color status LED		✓		✓		✓		✓
Compatible with Booster Kit		✓		✓		✓		✓
304L stainless steel body		✓		✓		✓		✓
Stainless casting electromechanical core		✓		✓		✓		✓
Robotic arm		-		✓		✓		✓
Compatible with Jumbo Kit		-		✓		✓		-
Protection for tubing nozzle		-		✓		✓		✓
Up to 6 pumps		-		-		✓		✓
Multi-dispensing mode (Patented)		-		-		✓		✓
Powder mode		-		-		✓		✓
Weighing mode		-		-		✓		✓
Auto-tare function		-		-		✓		✓
24 editable programs		-		-		✓		✓
Bidirectional connectivity		-		-		✓		✓
1 g dilution to 1/10 <sup>th</sup>		-		-		-		✓
Resolution up to 200 g					0.01 g			
Weighing range	0.1 to 3 000 g				0.1 to 5 000 g		0.1 to 1 000 g	
Max weight without support	4 500 g				7 000 g		1 500 g	
Weighing accuracy	0 to 100 g: ± 0.05 g 100 to 3 000 g: ± 0.1%				0 to 100 g : ± 0.05 g 100 to 5 000 g: ± 0.1%		0 to 20 g: ± 0.01 g 20 to 1 000 g: ± 0.1%	
Dilution factor	1/2 to 1/99				1/2 to 1/1000, customizable fractions			
Dilution accuracy/distribution	> 99% in Standard or Accurate mode (in optimal conditions)							
Dilution time for a 25g sample diluted to 1/10 <sup>th</sup>	< 9 s (with Booster Kit in Fast mode)				< 8 s (with Booster Kit in Fast mode)			
Dilution time for a 375g sample diluted to 1/10 <sup>th</sup>	-		< 80 s (with Booster Kit in Fast mode)		< 75 s (with Booster Kit in Fast mode)		-	
Distribution time for 90 mL	< 7 s (with Booster Kit in Fast mode)				< 6 s (with Booster Kit in Fast mode)			
Distribution time for 225 mL	< 10 s (with Booster Kit in Fast mode)				< 9 s (with Booster Kit in Fast mode)			
Max number of pumps	2 integrated				2 integrated + 4 external			
Dilution/distribution mode	Fast - Standard - Accurate							
Traceability	Printer / Supervision software (export to Excel™ / OpenOffice™, CSV file, printer)				Printer / Export to Excel™ file / CSV file Export on USB key / LIMS			
Exported data	Sample weight / Total weight / Dilution factor / Dilution accuracy / Right or left pump + with supervision software: Sample number / Name of operator / Date / Time				Sample weight / Total weight / Dilution factor / Dilution accuracy / Diluent / Sample number / Diluent lot number / Date / Time / Last calibration date / Name of operator / Name of program			
Connection	RS232 output for printer / USB port for computer / Jack output for foot pedal connection				2 USB ports (type A) to connect a printer, keyboard, bar-code reader, USB key / 1 USB port (type B) to connect a computer / Jack socket to connect a foot pedal / Handy gun / Ethernet connection for LIMS			
Language	English				French, english			
Net weight	10.1 kg	12.5 kg	12.3 kg	14.8 kg	12.8 kg	15.3 kg	12.9 kg	15.2 kg
Dimensions (w x d x h)	31.3 x 43.7 x 39.4 cm ; 37 x 43.7 x 39.4 cm ; 31.3 x 42.1 x 37.7 cm ; 37 x 42.1 x 37.7 cm ; 31.3 x 42.1 x 37.7 cm ; 37 x 42.1 x 37.7 cm ; 31.3 x 42.1 x 37.7 cm ; 37 x 42.1 x 37.7 cm							
In compliance with	ISO 7218 - ISO 6887							
Warranty after recording the warranty card	1 year							

\* with booster kit in standard or accurate mode \*\*with booster kit in fast mode

Certified production:



Products made for INTERSCIENCE by Interlab, an ISO 9001 certified company.



Proudly Distributed by:

**Cell Biosciences**

Ph: 03 9416 7177

Fax: 03 8678 3956

email: [info@cellbiosciences.com.au](mailto:info@cellbiosciences.com.au)

Web: [www.cellbiosciences.com.au](http://www.cellbiosciences.com.au)

**interscience**

**PARIS**

Phone: +33 (0)1 34 62 62 61 - Email: [info@interscience.com](mailto:info@interscience.com)

**FRANKFURT**

Phone: +49 611 7238 7770 - Email: [sales.germany@interscience.com](mailto:sales.germany@interscience.com)

**BOSTON**

Phone: +1 781 937 0007 - Email: [sales.usa@intersciencelab.com](mailto:sales.usa@intersciencelab.com)

**SHANGHAI**

Phone: +86 (0)21-64739390 - Email: [sales.china@interscience.cn](mailto:sales.china@interscience.cn)

**SINGAPORE**

Phone: +65 6977 7232 - Email: [sales.asia@interscience.com](mailto:sales.asia@interscience.com)

**TOKYO**

Phone: +81 3 6712 9715 - Email: [sales.japan@interscience.com](mailto:sales.japan@interscience.com)

[www.interscience.com](http://www.interscience.com)

# Scan<sup>®</sup>

Automatic colony counters & inhibition zone readers

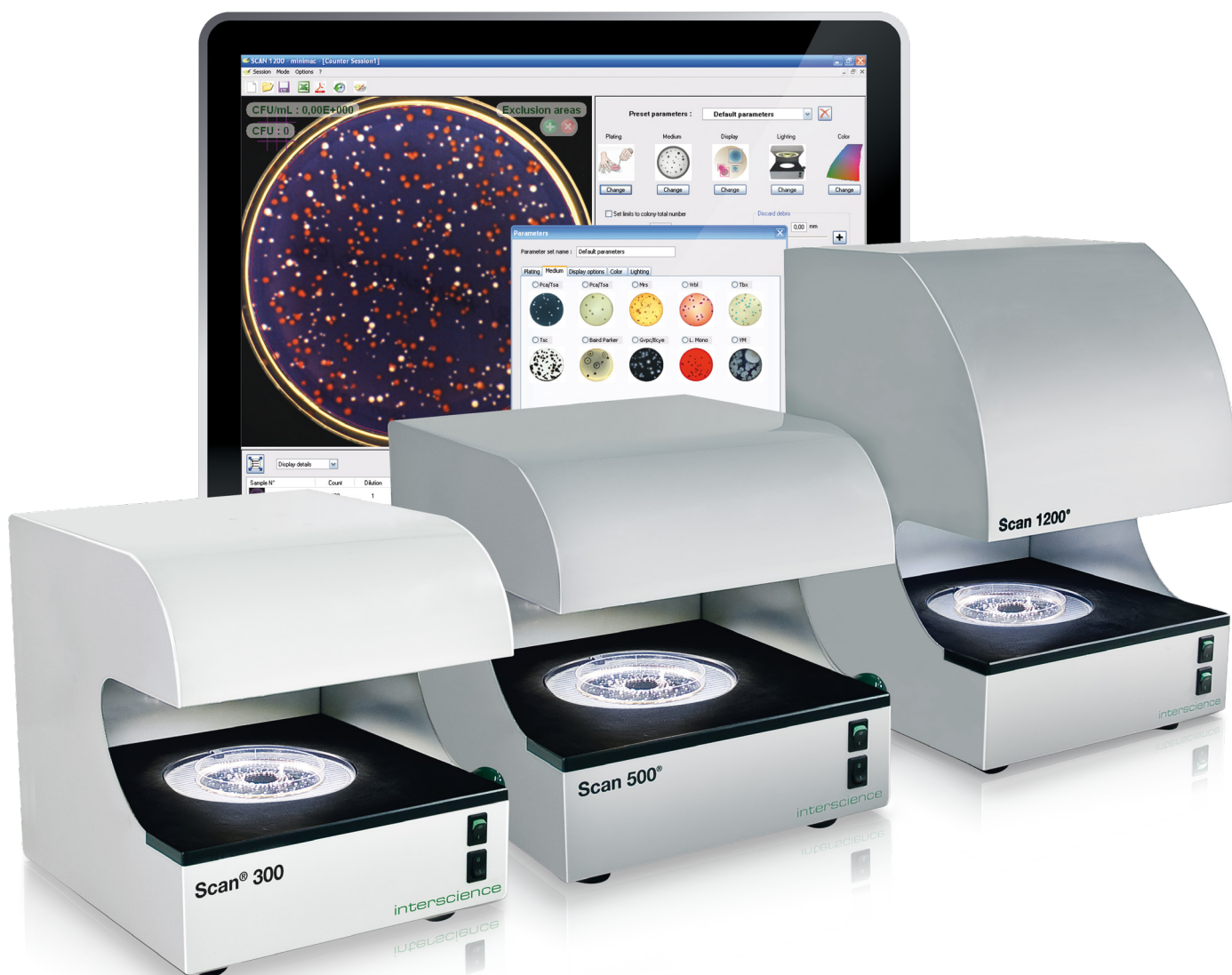





# interscience

## Our quality for your lab

- Designer and manufacturer for microbiological analyses
- Made in France
- Colony counting specialist
- Worldwide distribution network

## High quality analyses, full traceability

### **Scan<sup>®</sup> 300, Scan<sup>®</sup> 500 & Scan<sup>®</sup> 1200**

High technology automatic colony counters

With a digital camera and high technology software, they can be linked to a PC via a USB connection. They count all colonies on a Petri dish in less than 1 second and provide a complete, fast, accurate and traceable reading of the result.

## ■ Bacterial enumeration

- Food analyses
- Total flora analyses
- Aerobic & anaerobic bacterial enumeration, yeasts, lactobacillus...
- Pathogenic bacteria research
- Environmental research
- Pharmaceutical analyses
- Medical analyses
- Cosmetics analyses

## ■ Inhibition zones

- **Pharmaceutical industry, medical research & hospitals**  
(antibiograms, resistance tests to pathogenic microbes, medical diagnoses...)
- **Food industry**  
(Tests on lactic ferments & for dairy ingredients industry...)

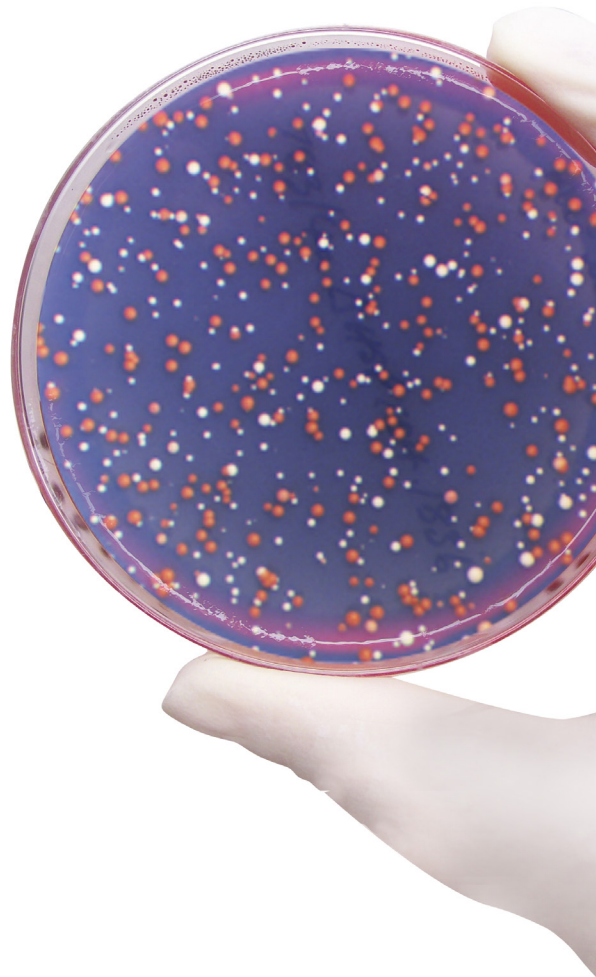



# Scan®

- Automatic colony counters: No settings
- Inhibition zone readers\*
- Data traceability and full report

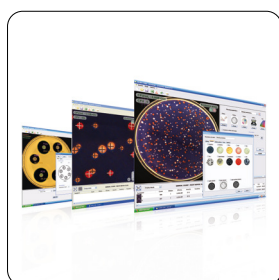





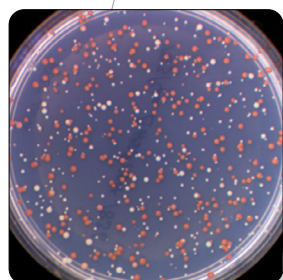

## High performance

- > Count colonies of numerous media
- > Reading of chromogenic media<sup>(1)</sup>: Colored differentiation of colonies (up to 7 different colors on the same dish)
- > Inhibition zone measurement



## Live image

- > Fits any type of dish: automatic adjustment of contrast and lighting
- > High-definition color image
- > Each colony is marked with a cross
- > Powerful zoom: up to x28

Display details			
Sample N°	Count	Dilution	
 E COLI	174	1 2.0	
 E COLI	353	1 5.0	
 SPIRAL	47	1/1000 9.0	
 PETRIFILM	89	1 8.0	
 RIDA COUNT	179	1 1.0	
 Filtering Membrane	111	1 1.0	

## Instant results

- > Up to 1000 colonies detected in 1 second
- > Counts 30 dishes in 5 minutes (in real condition with presetting)
- > Reproducible and standardized results
- > **Scan®** results: instant and automatic



(1) on Scan® 500 & Scan® 1200





## Easy-to-use

- Counting in 1 click <
- All functions in 1 single window <
- Custom parameters: day, users, project... <

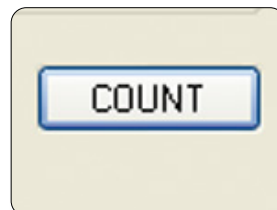

## Dark Field technology

- Display of every colony <
- Optimized lighting & contrast <
- Long lasting LED lighting <
- 6 lighting combinations <



## Traceability & reporting

- Automatic archiving and printing of data: <
  - pictures, comments & results
- Export to EXCEL™, PDF, JPEG, PNG, BMP <
- Barcode reader <
- Connection to LIMS network <

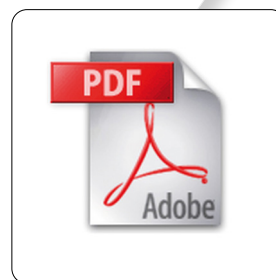

**DOWNLOAD  
SCAN® SOFTWARE**

[www.interscience.com](http://www.interscience.com)



(2) Free update of the software during warranty period (3) After registration of the warranty form

# Efficiency & time saving

## Instant results

Thanks to the live image display of the Petri dish on your computer, count more than **1000 CFU/s** on all media. Each counted colony is marked with a cross and the result is automatically saved.

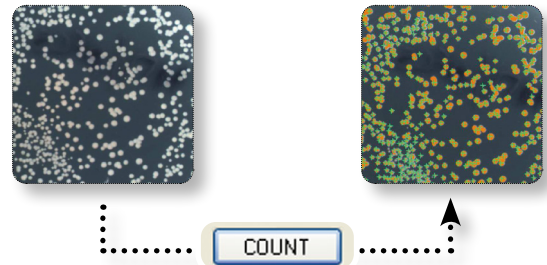

## No settings

Choose your pre-set parameters for Petri dishes:

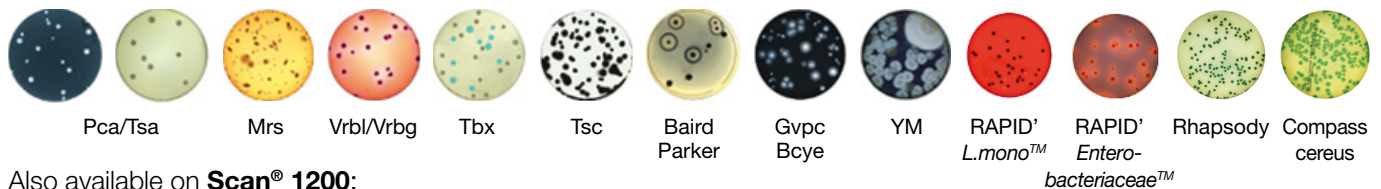

Also available on **Scan® 1200**:

- MC-Media Pads™: AC, CC, EC/CC, SA
- Petrifilm™: AC, ETB, CC, EC/CC, EC
- Compact Dry™: TC, CF, EC, ETB
- Easy Plate™
- Filtration membranes

## High-performance colony counters

**Scan®** works for every kind of colony. The minimum size is **0.05 mm for Scan® 1200** and **0.1 mm for Scan® 300** and **Scan® 500**. **Scan®** colony counter automatically separates confluent colonies, allows you to create polygonal exclusion areas and ignores agar flaws and air bubbles. You can also add or remove colonies manually. Every change is automatically saved in your report.

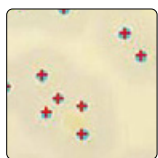

Scan® read all the colonies, even the smallest

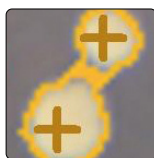

Automatic separation of confluent colonies

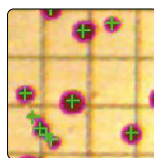

Automatic elimination of counting grids

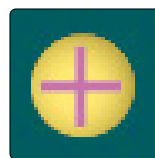

Cross on each counted colony

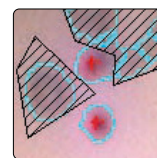

Polygonal exclusion areas



Automated software with manual control

## Color detection & chromogenic media

**Scan® 500** and **Scan® 1200** can read chromogenic agar and differentiate colonies by color: **up to 7 different colors on the same Petri dish**. Color selection can be made directly from the color of the bacteria and a cursor allows you to set the sensitivity.

Chromogenic media reading allows the detection of *Salmonella* on XLD media and *E.Coli* on TBX media, for example.

\* on Scan® 500 & Scan® 1200

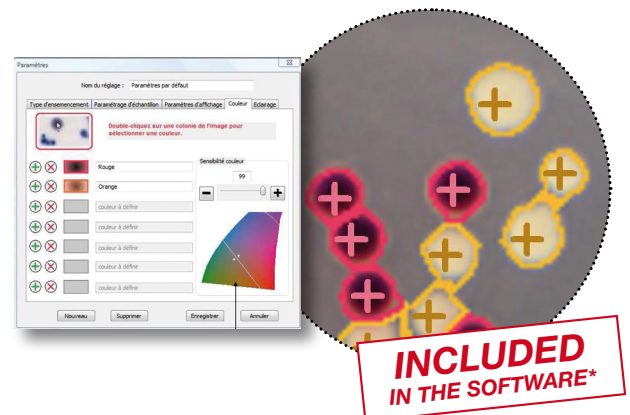

# Scan® : 3 models adapted to your needs



## Scan® 300 Essential

Ref 436 300

- 6 combinations of lighting and backgrounds
- Motorized background color
- Brightness, contrast and sensitivity are automatically optimized by the software
- Long lasting LED lighting
- CMOS color camera, zoom x28, M12 lens
- Minimum size of detected colony: 0.1 mm

### Count these supports

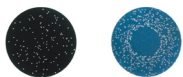

Surface/pour plating  
Spiral® plating



## Scan® 500 Efficient

Ref 436 000

- 6 combinations of lighting and backgrounds
- Motorized background color
- Brightness, contrast and sensitivity are automatically optimized by the software
- Long lasting LED lighting
- CMOS color camera, zoom x28, M12 lens
- Minimum size of detected colony: 0.1 mm
- Detects and counts up to 7 colors on the same dish
- Inhibition zone reading with EUCAST, CA-SFM, CLSI and editable database

### Count these supports

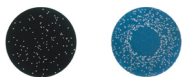

Surface/pour plating  
Spiral® plating



Chromogenic Petri dishes  
Antibiogram



## Scan® 1200 High-Resolution

Ref 437 000

- 6 combinations of lighting and backgrounds
- Motorized background color
- Brightness, contrast and sensitivity are automatically optimized by the software
- Long lasting LED lighting
- Color HD CCD camera, zoom x28, HD Japanese lens
- Minimum size of detected colony: 0.05 mm
- Detects and counts up to 7 colors on the same dish
- Inhibition zone reading with EUCAST, CA-SFM, CLSI and editable database
- Petrifilm™, Compact Dry™, MC-Media Pads™, Easy Plate™ and filtration membrane reading

### Count these supports

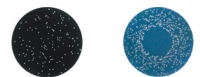

Surface/pour plating  
Spiral® plating



Chromogenic Petri dishes  
Antibiogram



Petrifilm™  
Compact Dry™  
MC-Media Pads™  
Easy Plate™

Filtration membranes  
Circle



# Inhibition zone from paper discs, agar wells & peni cylinders

## Performance and flexibility

**Scan® 500** and **Scan® 1200** allow efficient work flow because you can create and edit a list of antibiotics, useful for routine analysis.

Measured by **Scan®**, inhibition zones guarantee repeatability and reproducibility of analysis and diagnosis reliability.

- Rapid detection: up to 8 antibiotic sensitivities in 1 click.
- Paper discs, agar wells and peni cylinders may be manually added or deleted. Inhibition zones may be manually resized.

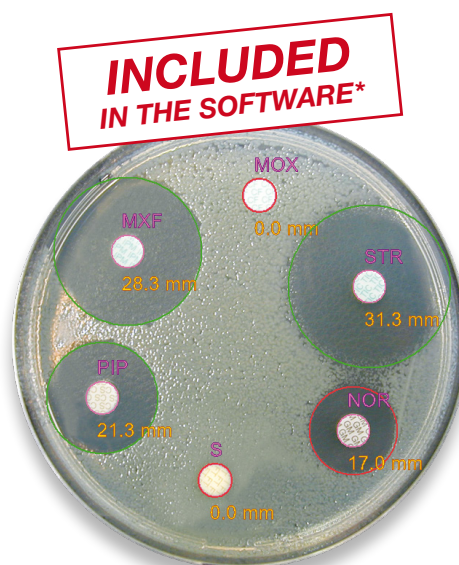

The result of sensitivity in contact with the antibiotic is fast and visualization of results is clear:

- > Red (resistant)
- > Yellow (intermediate)
- > Green (susceptible)

## Medical analysis

Inhibition zone measurement allows you to test the efficiency of antibiotics on micro-organisms to accelerate the diagnosis in order to choose precisely an appropriate antibiotic treatment for a patient. **Scan®** has a built-in antibiotic database from the **French Society of Microbiology (CA-SFM)**, the **European Committee on Antimicrobial Susceptibility Testing (EUCAST)** and the **Clinical and Laboratory Standards Institute (CLSI)** which determines the sensitivity of the bacteria to the antibiotic. This database is fully editable.



Precision of inhibition zone radius measurement from paper discs : 0.3 mm

## Pharmaceutical analysis

In the pharmaceutical industry, **Scan®** allows you to test the quality of an antibiotic during its manufacturing process by measuring the inhibition zones. To evaluate the action of an antibiotic, antibiotic diffusion from paper disc, agar well or peni cylinder is supported.

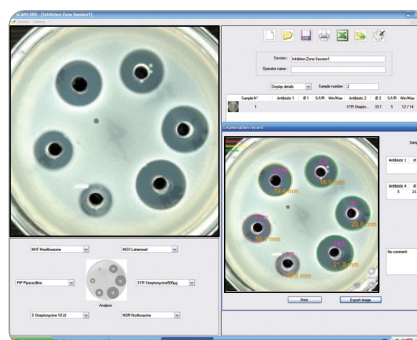

Precision of inhibition zone radius measurement from agar wells : 0.3 mm



\* on Scan® 500 & Scan® 1200



# Comfort of use

## > High definition live image

This feature enables total control of colony counting.

## Optimum visualization

Enjoy comfortable viewing of the colonies with the unequalled **Dark Field technology**, high definition live image and with the automatic optimization of the image (lighting, contrast and sensitivity). You can also check key areas thanks to the digital zoom.



Dark Field: LED are disposed in a circle for optimal contrast

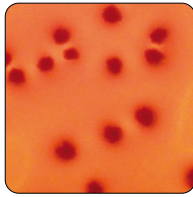

Scan® automatically optimizes contrast, luminosity and sensitivity

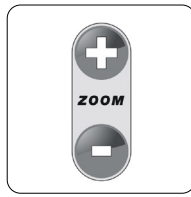

Digital zoom with the mouse wheel (up to x28)

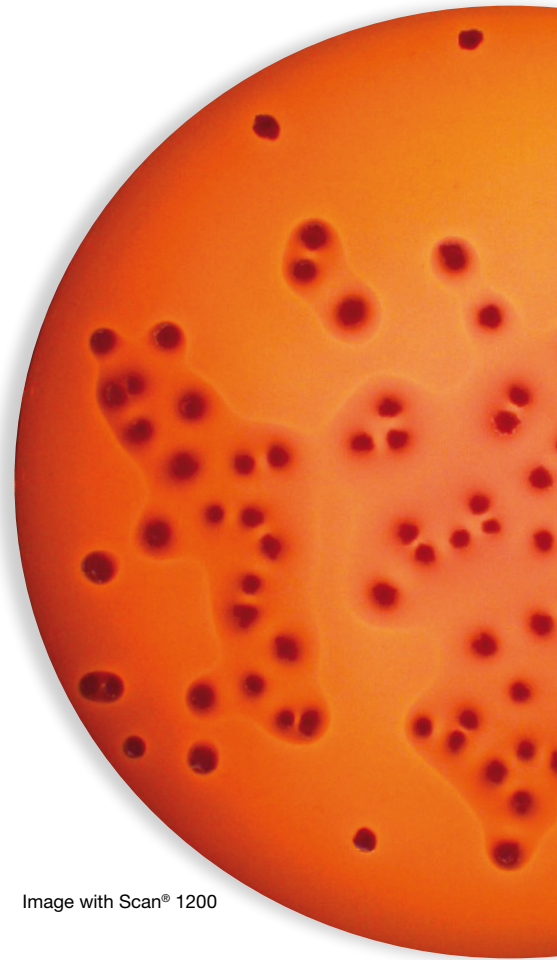

Image with Scan® 1200

## Easy-to-use

All **Scan®** functions are in **one single window** and colonies are counted in one click.

The **Scan®** easy commands (visualization, settings and results) allow quick access to both ongoing and archived work sessions.

**Scan®** software is available in **7 languages** (English, French, Chinese, Russian, Japanese, Spanish and German) and is updated regularly. The intuitive use of **Scan®** **does not require any special training**.

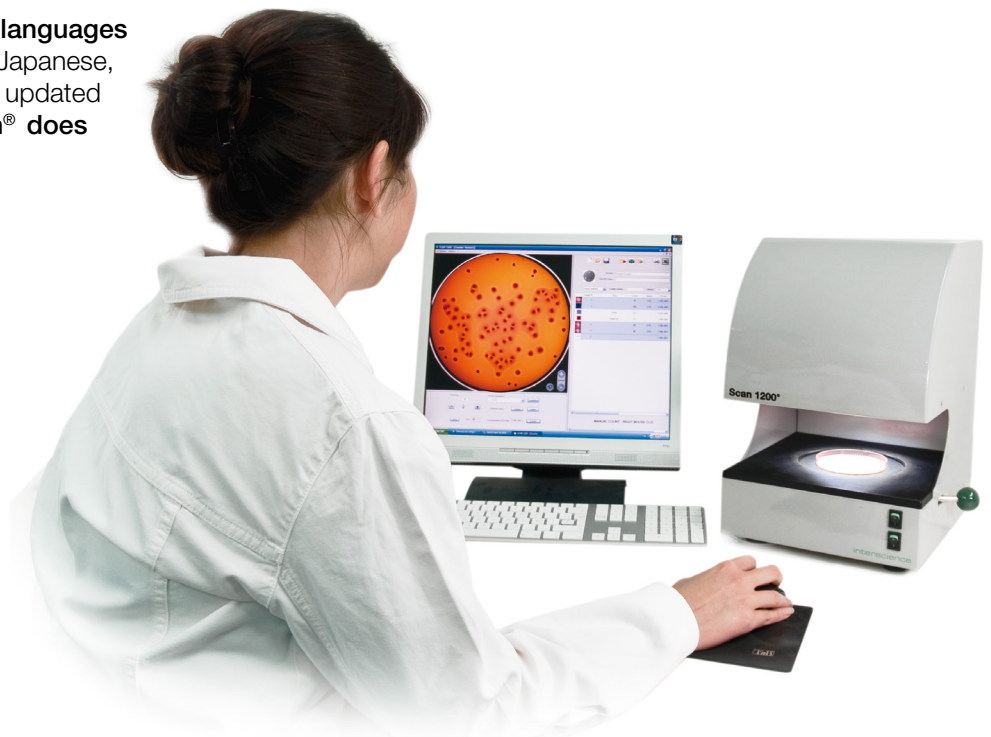

# Fast communication, total traceability

## Results harmonization

Using the **Scan**® allows more reliable analyses and harmonizes the results within a team.

You can save as many settings as you wish and customize the settings according to the type of dishes and agar you use.

The automatic archiving of data, photos, comments and results ensures total traceability.



## Print your results

You can export your results to your PC, archive it in Excel™, PDF, SCA or BIO format. You can also export pictures from the camera in JPEG, PNG and BMP format.

Add your own logo in the reports

interscience

Petri dish before counting

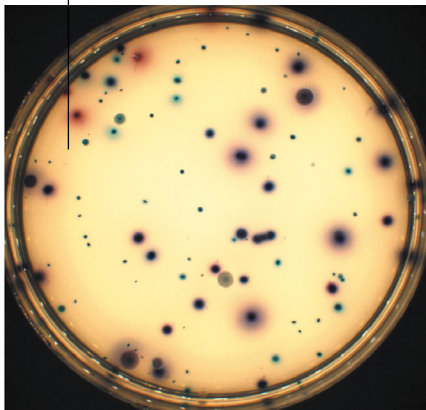

Sample

Petri dish after counting

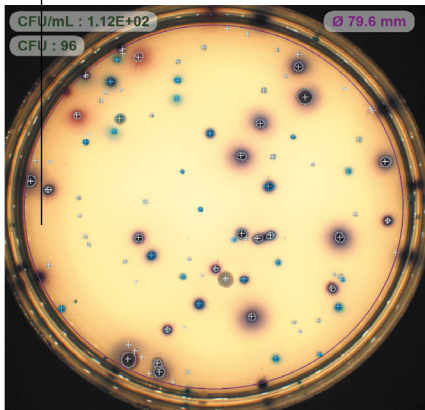

CFU/mL : 1.12E+02  
CFU : 96  
Ø 79.6 mm

Sample analysed with SCAN 1200®, version 7.0.2.0

Sample information	Operator name :	be	Sample N° :	2	CFU/mL :	1.12E+02
	Parameters :	Coli-Coliforms	Count :	96	Dilution :	1
	Date Time :	12/10/2014 9:52:13	Area (%) :	86 %		
Comments	Comment :		E. Coli :	23 CFU	2.68E+01	
	OK		Coliform :	73 CFU	8.51E+01	

Analysis result

Printed report example

## Reproducibility of results

Automatic counting is a guarantee of **regularity and standardization** of analyses, which is the key to ensure accurate and reliable results. **Reproducibility** of results is guaranteed whatever the day, conditions and user.

A scientific study has proven that **Scan®** colony counters can achieve an accuracy of up to 98%.

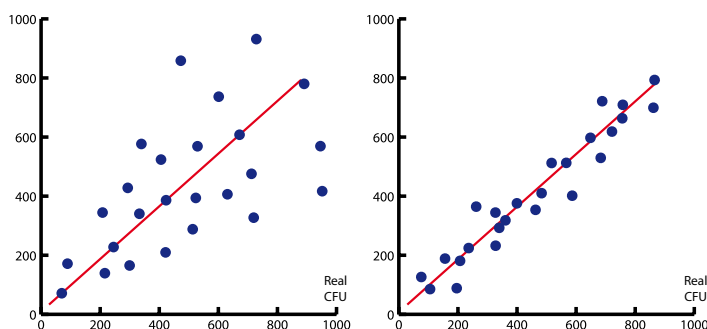

### Manual counting:

Random results over time and different users by manual counting of colonies

### Automatic counting:

Standardized and reproducible results by automatic counting

Study made on *Bacillus cereus*, *Escherichia coli* and *Lactobacillus casei*

## Internal traceability

Thanks to the **LIMS** connection and the barcode reader, photos of counted plates are **saved and traceable**. The images are accessible and recountable at any time.



Barcode



Archiving

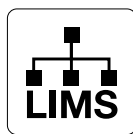

LIMS connection



dataLink™  
(see p. 12)

## Secure your sessions

Sessions are secured with a **security code** (one per operator) and the impossibility to alter each saved counting. **Scan®** use allows the compliance with **21 CFR part 11**: system securization, operational controls and documentation management.

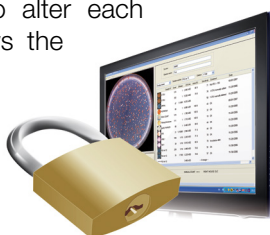

## > External traceability

Scan® software provides numerous possibilities to easily and quickly export your results.



Work sessions saving



PDF export



JPEG, PNG & BMP  
formats export

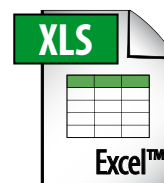

Export results to  
Excel™ to ensure  
traceability

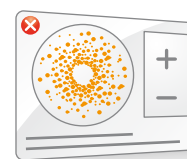

Print report from Scan®

# Plate & Count System<sup>®</sup> with dataLink<sup>™</sup>

**INCREASE**  
your lab capacity with  
**easySpiral<sup>®</sup> & Scan<sup>®</sup>!**



---

More info on  
[www.interscience.com](http://www.interscience.com)

---

**Plate & Count System<sup>®</sup> with dataLink<sup>™</sup>** enables automatic plating and colony counting with full traceability!

- **INCREDIBLE SAVINGS:** Save up to 75% in time, consumables and bench space
- **FAST:** Full plating cycle in 25 seconds and counting in 1 click. No manual data input.
- **RELIABLE:** 98% repeatable and reproducible results
- **TOTAL TRACEABILITY WITH dataLink<sup>™</sup>:** Automatic data saving and reporting

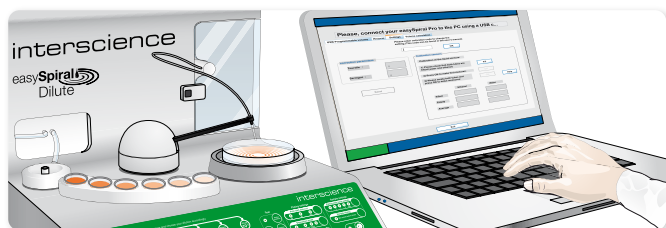

**Plate & Count System®** with dataLink™ includes:

- **easySpiral®**: Automatic Spiral® platers
- **Scan®**: Automatic colony counters
- dataLink™: Traceability system

## HOW DOES IT WORK?

### STEP 1



Plating with **easySpiral Pro®** or **easySpiral Dilute®**. The supervision software collects data from the plater.

### STEP 2



Label printing with the Datamatrix code. Stick the label on the plated Petri dish before incubation.

### STEP 3



... Incubation 24-72 h

After incubation, scan the Datamatrix code. The **Scan®** colony counter is parametered automatically with the Datamatrix data. Click on "VALIDATE". Export the data.

\* Please check LIMS compatibility

## PLATE AND COUNT YOUR PETRI DISHES

### ■ From 30 to 1x10<sup>12</sup> cfu/mL on one single petri dish

**easySpiral®** automatically plates a sample in **8 seconds**: from 30 to 1x10<sup>12</sup> CFU/mL on a **single Petri dish** without prior sample dilution. Once the sample is plated and incubated, it is ready to be counted by **Scan®** automatic colony counters. Results are immediately displayed and saved.

### ■ Up to 75% savings

**easySpiral®** and **Scan®** guarantee the regularity and standardization of the analyses, save time, consumables and bench space of up to 75 %.



# Technical specifications

		Scan® 300	Scan® 500	Scan® 1200
	Référence	436 300	436 000	437 000
OVERVIEW	Stainless steel body	✓	✓	✓
	LIMS/SIL connection	✓	✓	✓
	USB connection	✓	✓	✓
	Available with dataLink®/dataLink® pro traceability system	✓	✓	✓
	Counting on pour, surface, Spiral and circle plated Petri dishes	✓	✓	✓
	Counting on chromogenic dishes	-	✓	✓
	Counting on Petrifilm™, Compact Dry™, MC-Media Pads™, easyPlate™, filtration membranes	-	-	✓
	Automatic counting	✓	✓	✓
	Inhibition zone reader	-	✓	✓
	Minimal size of colony: 0.05 mm	-	-	✓
COUNTING	Counting	Automatic with manual control		
	Automatic separation of clustered colonies	✓	✓	✓
	Creation of polygonal exclusion zones	✓	✓	✓
	Manual control to add or subtract colonies	✓	✓	✓
	Counting time	Up to 1000 colonies per second		
	Minimal size of colony	0.1 mm		0.05 mm
INHIBITION ZONE READING	Antibiotic disc detection	-	Automatic with possibility to add or remove manually antibiotics	
	Automatic detection of antibiogram support	-	Disks (several brands simultaneously), wells, peni-cylinder (steel, plastic)	
	Display resolution	-	± 0.1 mm	
	Inhibition zone measurement accuracy	-	± 0.3 mm	
	Number of antibiotic paper disks	-	Up to 7 antibiotics on a Ø 90 mm Petri dish	
	Reading time	-	7 inhibition zone reading between 1 to 3 seconds	
	Interpretation system	-	CA-SFM Human health / EUCAST / CA-SFM Veterinary / CLSI (Clinical, Laboratory Standards Institute) / Customizable list	
SPECIFICATIONS	Color camera	CMOS		HD CCD
	Lens	M12 Lens		HD japanese lens
	Zoom	x 28		
	Resolution (megapixels)	1		1.2
	White LED Lighting technology	Dark Field		
	LED Lighting system	Automatic with 6 combinations, top and/or bottom light, white or black background		
	Petri dish dimensions	Ø 55 mm - Ø 90 mm		
	Color detection	-	7 colors on the same dish + 1 color to exclude	
	USB Data export	to LIMS, PDF report, jpg, png and bmp images, Excel™ recountable session		
	Data security	Modified data traceability in conformity with 21 CFR part 11		
	Results/traceability	Image / sample number / comments / date / time	Image / sample number / comments / date / time / antibiotic name / bacterial name / diameter read / SIR categorized result with color code / minimum and maximum critical diameter	
	Languages	English, French, Japanese, Chinese, Russian, Spanish, German		
	Warrantie	3-year (after recording the warranty card)		
	Spare parts availability	10 years		
	In compliance with	21 CFR Part 11, ISO 7218 and AOAC 977.27		
PC MINIMUM REQUIREMENTS	Operating sytem	Windows™ 10 or 11 (or higher)		
	Processor	Intel i5 2.8 GHz Quad-Core or higher		
	RAM	4 GB for use of the Scan		
	Equipments	1 USB port free		
	Screen	1280 X 1024 pixels or superior higher		
	Software updates after recording the warranty card	3-year		

Scan® 300: delivered with 1 Scan® software, 1 15V power supply, 1 USB cable, 2 validation plates, 1 user manual.

Scan® 500 / Scan® 1200: delivered with: 1 Scan® software, 1 15V power supply, 1 USB cable, 3 validation plates, 1 user manual.

PC requirements are subject to change. Please check our website [www.interscience.com](http://www.interscience.com) for current updates and additional informations.



Product made for INTERSCIENCE by Interlab, an ISO 9001 certified company

# Scan® accessories



dataLink™  
Ref. : 410 100



Barcode reader  
Ref. : 522 000



Adaptor for  
Petrifilm™\*  
Ref. : 437 002

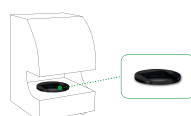

Adaptor for  
MC-Media Pads™\*  
Ref. : 437 001

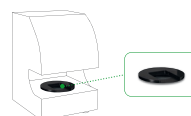

Adaptor for  
Compact Dry™\*  
Ref. : 437 004



Adaptor for  
Petri dish (55 mm)  
Ref. : 436 005

\* Only on Scan® 1200

## Discover our complete range for microbiology

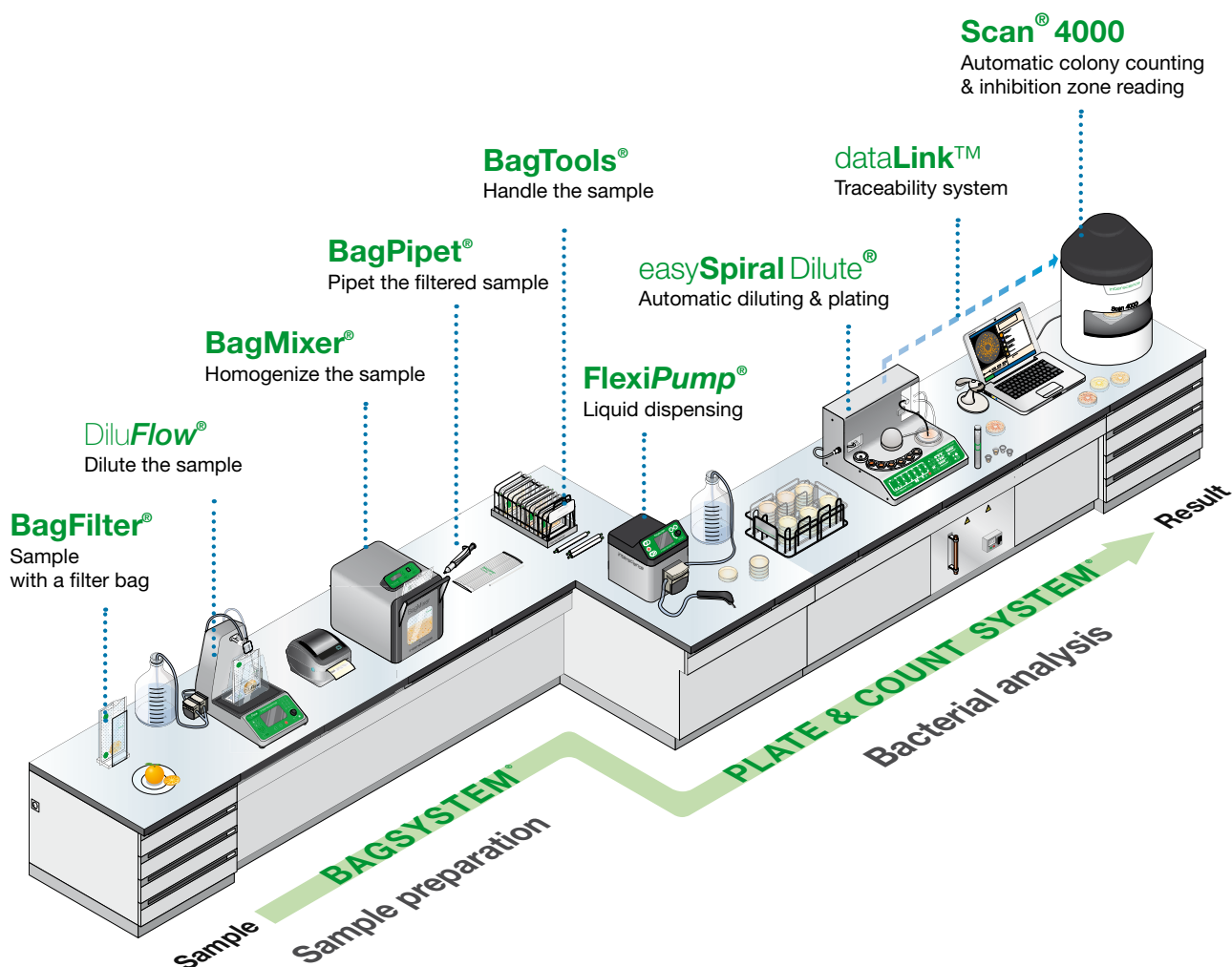

[www.interscience.com](http://www.interscience.com)



DOWNLOAD  
SCAN® SOFTWARE

[www.interscience.com](http://www.interscience.com)

On our website, find and download:

- Latest information on our products
- Demonstration photos and videos



interscience

## PARIS

Phone: +33 (0)1 34 62 62 61

Email: [info@interscience.com](mailto:info@interscience.com)

## FRANKFURT

Phone: + 4 9 6 1 1 7 2 3 8 7 7 7 0

Email: [sales.germany@interscience.com](mailto:sales.germany@interscience.com)

BOSTON

Phone: +1 781 937 0007

Email: [sales.usa@intersciencelab.com](mailto:sales.usa@intersciencelab.com)

## SHANGHAI

Phone: + 86 (0) 21 - 64739390

Email: [sales.china@interscience.cn](mailto:sales.china@interscience.cn)

SINGAPORE

Phone: + 6 5 6 9 7 7 7 2 3 2

E-mail: [sales.asia@interscience.com](mailto:sales.asia@interscience.com)

## TOKYO

Phone: + 8 1 3 6 7 1 2 9 7 1 5

E-mail: [sales.japan@interscience.com](mailto:sales.japan@interscience.com)

**Proudly Distributed by:**

**Cell  
Biosciences**

**Ph: 03 9416 7177**

**Fax: 03 8678 3956**

**email: [info@cellbiosciences.com.au](mailto:info@cellbiosciences.com.au)**

**Web: [www.cellbiosciences.com.au](http://www.cellbiosciences.com.au)**



# PocketSwab Plus ATP Swab for Surface Hygiene Verification

## Product Overview

The Charm<sup>®</sup> PocketSwab<sup>®</sup> Plus ATP Swab (PocketSwab Plus swab) is a room-temperature stable, self-contained, single service swab that enables total surface hygiene verification for ATP (adenosine triphosphate) in only 5 seconds, allowing real-time corrective action.

This high sensitivity swab is relied on for cleaning validation, prevention of cross-contamination, infection control, HACCP audits and enforcement across multiple industries.

## Benefits of PocketSwab Plus Swab Include:

- 5 Second results = Faster Pre-op Inspection
- Enhanced sensitivity to ATP = Reduced microbial counts
- Reduced consumer complaints
- Room temperature stable with 12-month shelf life = Reduced freight cost with bulk packaging
- Recyclable components = Reduced waste

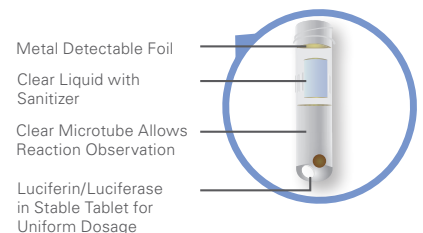
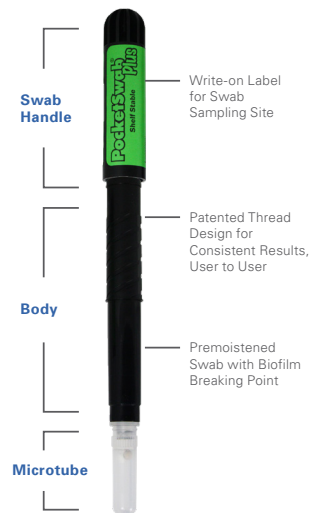

## Simple Procedure with the novaLUM<sup>®</sup> II-X System

**1**

**Swab**

**2**

**Twist and Shake**

**3**

**Insert Swab**

**4**

**Read using the  
novaLUM II-X system**

## Industries

Industries used for:				
Animal Care	Beverage	Clean Room	Cosmetics	Environmental
Food	Grain	Health Care	Medical Devices	Nutraceuticals
Personal Care Products	Pharmaceuticals	Pulp & Paper	Truck Wash	Water Treatments
Wineries				

## Swab Extender

More Charm customers are incorporating Swab Extenders to monitor hard-to-reach and inaccessible areas in their Sanitation Standard Operating Procedures (SSOPs).

Available in 3 and 16 foot (0.9 m and 4.9 m) lengths, users can simply lock the relevant Charm ATP swab into the extender and adjust the angle to reach their target.



## Ordering Information

Order Codes	Each Kit Includes
POCK-PLUS-25K	PocketSwab Plus 25 Kit
POCK-PLUS-100K	PocketSwab Plus 100 Kit
POCK-PLUS-1000K	PocketSwab Plus 1000 Kit
150-0035	3 ft (0.9 m) Extender
150-0040	16 ft (4.9 m) Extender

See Operator's Manual for additional kits and order codes.

Proudly Distributed by:

**Cell  
Biosciences**

Ph: 03 9416 7177  
Fax: 03 8678 3956  
email: [info@cellbiosciences.com.au](mailto:info@cellbiosciences.com.au)  
Web: [www.cellbiosciences.com.au](http://www.cellbiosciences.com.au)

[www.charm.com](http://www.charm.com)

T +1.978.687.9200 | F +1.978.687.9216 | E [info@charm.com](mailto:info@charm.com) | 659  
Andover Street, Lawrence, MA 01843-1032

© 2022 Charm Sciences, Inc. | Charm, PocketSwab, and novaLUM are registered  
trademarks, and test strip product packaging is trade dress, of Charm Sciences, Inc.  
| MRK-045-008 Jun-2022

**CHARM**  
SCIENCES INC  
NOTHING WORKS LIKE A CHARM



**Cell**  
**Bi**  **Sciences**



#### Customer Testimonial

“Charm Peel Plate Microbial Tests are simplified culture methods. Charm Peel Plates have provided exceptional benefits to our manufacturing plant. The ease of use was a must have for us. We were able to teach plant operators, who have no lab background, how to dilute and properly plate, incubate, and read samples without having to hire additional staff. Now, we can plate our samples, wait the short period for the results, and package or immediately implement corrective actions.

The plates have saved us significant time and money.”

-Annette C.  
Simmons Grain Co.

## Charm® Peel Plate® Microbial Tests

Simplified Culture Method For Detecting Microorganisms



# Introduction

**Charm Peel Plate Microbial Tests are simplified culture methods for detecting microorganisms.** AOAC-RI granted performance tested method status to Charm Peel Plate AC, EC, and YM tests. The Peel Plate EB Microbial Test received MicroVal certification harmonized with AOAC Official Method of Analysis First Action Status. The methods follow conventional microbiologic procedures for time and temperature of incubation. An air gap between the plate and cover allows colony picking and determination of microbial morphology. Peel Plate tests are for use in dairy products, ground meats, other foods, contact environmental surfaces, and water. There are 1 mL sample volume Peel Plate tests for aerobic bacteria (Peel Plate AC test), heterotrophic count (Peel Plate HET test) and *Staphylococcus Aureus* (Peel Plate SA test). There are 1 mL and 5 mL (High Volume) tests for coliform count (Peel Plate CC test), coliforms/*E. coli* (Peel Plate EC test), enterobacteriaceae (Peel Plate EB test), and yeast and mold (Peel Plate YM test).

Each version of these tests contains non-selective or selective medium with color producing enzyme substrates to produce visible colonies.

# Charm Peel Plates

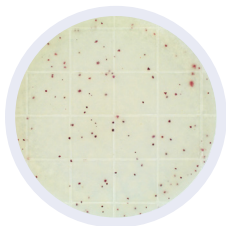

## Charm Peel Plate AC Microbial Test

(Aerobic Count) use conventional standard plate count formulation with red producing TTC enzyme substrate. Aerobic bacteria produce red colonies.

- Improved anti-spreader formulation
- Improved detection of aerobic bacteria
- Applicable for use with LPC testing
- Approved for use with NCIMS/PMO and FDA 2400
- Performance Test Validated for 15 food and dairy matrices AOAC-RI 071501

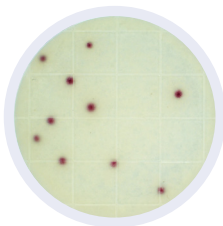

## Charm Peel Plate CC Microbial Test

(Coliform) use conventional EC media with color producing enzyme substrates and produce easy to interpret red colonies.

- Recovers 25% more coliform bacteria strains than competing methods
- No gas/acid interpretation required
- Approved for use with NCIMS/PMO and FDA 2400

A Peel Plate CC Microbial Test for Cultured Dairy is also available. High Volume versions are available for 5 mL samples.

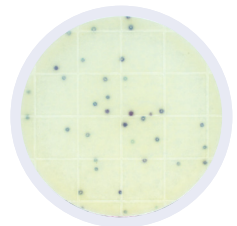

## Charm Peel Plate SA Microbial Test

(*Staphylococcus aureus*) use conventional Baird Parker Agar formulation with dark purple producing enzyme substrate. *Staphylococcus aureus* produce purple colonies larger than a pinpoint and may contain white centers.

- Incubate 48 hours for confirmation of presumptive positive (no overlay required)

A Peel Plate SA Microbial Test for Cultured Dairy is also available. High Volume versions are available for 5 mL samples.

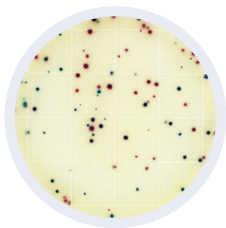

## Charm Peel Plate EC Microbial Test

(*E. coli* and Coliform) use conventional EC media with color producing enzyme substrates. Coliforms produce easy to interpret red colonies. Generic *E. coli* produce blue/purple colonies.

- Approved for use with NCIMS/PMO and FDA 2400
- Performance Test Validated for 15 food and dairy matrices AOAC-RI 061501

A Peel Plate EC Microbial Test for Cultured Dairy is also available. High Volume versions are available for 5 mL samples.

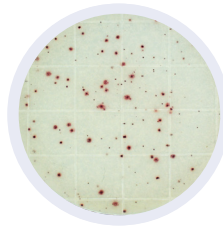

## Charm Peel Plate HET Microbial Test

(Heterotrophic Count) use conventional R2A formulation with red producing TTC enzyme substrate. Heterotrophic bacteria produce red colonies.

- Improved detection of heterotrophic bacteria

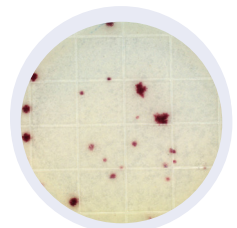

## Charm Peel Plate Y Microbial Test

(Yeast) use media containing selective agents and dyes to produce dehydrogenase enzymes, which react with a redox indicator to produce red or pink colored colonies.

- Suppresses mold growth to select for yeast colony growth only, particularly for use in foods naturally containing molds, i.e. bleu cheese.





# Peel Plate Colony Counter



Save time counting plates with Charm's Peel Plate Colony Counter III! This stand-alone unit provides valuable data tracking software and easily connects and imports to an existing SQL (or compatible) database. The unit takes a photo of the plate and counts and reports the number of colonies present. Raw and processed images are saved as .jpg files and can be exported with the data to a .csv file.

**Want to learn how you can strengthen your sanitation and hygiene monitoring programs? Contact us today for a free consultation.**

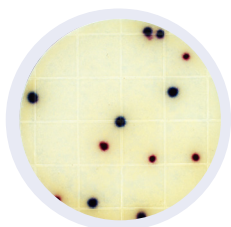

## Charm Peel Plate EB Microbial Test

(Enterobacteriaceae) use conventional EB formulation and produce colored colonies.

- MicroVal and AOAC OMA 2018.05 approved for specific food matrices in applicable industries
- No gas/acid interpretation required
- Validated for relevant, industry specific matrices

A Peel Plate EB Microbial Test for Cultured Dairy is also available. High Volume versions are available for 5 mL samples.

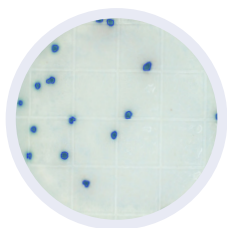

## Charm Peel Plate YM Microbial Test

(Yeast and Mold) use conventional Potato Dextrose Agar (PDA) formulation and produce blue/green colonies.

- Contains antibiotic to suppress growth of bacteria
- Performance Test Validated for 8 food matrices  
AOAC-RI 061601

High Volume versions are available for 5 mL samples.

## Benefits of Charm Peel Plate Microbial Tests

- **Ready-to-use. Just add sample dilution. No spreading device needed.**
- **Etched grid lines for estimated counts.**
- **Colonies easily picked for additional isolation/classification.**
- **Convenient plate stacking for improved air circulation.**
- **Buffered formulation – pH adjustment not required for most samples.**
- **12 month room temperature or refrigerated shelf-life in a resealable foil zip bag.**



## Procedure

The tests are prepared media in a shallow dish with an adhesive top. Just add the sample to the middle and it diffuses through the media and solidifies. Invert the test, stack multiple tests together (if appropriate), and incubate. The Peel Plate tests are intended for microbiological laboratories, but may also be used by food quality stakeholders such as farmers, milk processors, and water municipalities.

### Simple procedure with clear and accurate results:



**Peel**



**Vertically Pipet**  
within 2 to 3 seconds



**Seal**



**Incubate**  
at specified temperature and times.

### Time and incubation:

	AC	CC	EB	EC	HET	SA	YM
Time	48 ± 3 hr	24 ± 2 hr	24 to 48 hr	24 ± 2 hr	5 to 7 days	24 to 48 hr	3 to 5 days
Temperature							
Dairy	32 °C ± 1°	32 °C ± 1°	37 °C ± 1°	32 °C ± 1°	N/A	35 to 37 °C	25 °C ± 3°
Water	N/A	N/A	N/A	35 °C ± 1°	20 to 28 °C	N/A	N/A
Other Products	35 °C ± 1°	35 °C ± 1°	37 °C ± 1°	35 °C ± 1°	N/A	35 to 37 °C	25 °C ± 3°

## Sanitation Verification Tools

**Charm's Integrated Sanitation Monitoring uses ATP and Peel Plate tools for cleaning verification. It empowers food facilities to take action against hygienic threats and prepares the facility to meet compliance regulations.** There is an increased focus in the food industry on food-safety monitoring. Food manufacturers, processors, packagers and handlers must identify safety hazards and adapt process controls to reduce the risk of hazards. Cleaning is a universal process control in food manufacturing. Charm provides tests that are fast and reliable for cleaning verification, prevention of cross-contamination, and infection control. Charm tests help industries meet 3rd party and process control documentation requirements.



**PocketSwab® Plus ATP Test  
& novaLUM® II-X System**

Proudly Distributed by:

**Cell  
Biosciences**

Ph: 03 9416 7177  
Fax: 03 8678 3956  
email: [info@cellbiosciences.com.au](mailto:info@cellbiosciences.com.au)  
Web: [www.cellbiosciences.com.au](http://www.cellbiosciences.com.au)



[www.charm.com](http://www.charm.com)

T +1.978.687.9200 | F +1.978.687.9216 | E [info@charm.com](mailto:info@charm.com) | 659 Andover Street, Lawrence, MA 01843-1032, USA

© 2021 Charm Sciences, Inc. | Charm, novaLUM, Peel Plate, and PocketSwab are registered trademarks of Charm Sciences, Inc. | MRK-1052-009 Oct-2021